

SURROUND SOUND – ON YOUR SHOULDERS

Customized. Comfortable. Close.



BeHear PROXY is a unique combination of a wireless neck speaker and personal hearing amplifier - powered by Alango's advanced audio technology.



CUSTOMIZED – according to your unique hearing profile.



COMFORTABLE – lightweight speaker, high quality crisp sound while leaving your ears free. Suitable for use with hearing aids.



CLOSE – brings sound close to your ears for a personal, immersive experience. Extractable earbuds enable private listening.



TV Watching

- ▶ Rich stereo sound, inches from your open ears
- ▶ Pairs simultaneously and switches easily between TV and smartphone



Mobile Calls & Streaming

- ▶ Loud and clear mobile calls, podcasts, streamed videos, and video conferences
- ▶ EasyListen™ imperceptibly slows down incoming speech for better comprehension



Personalized Amplification

- ▶ Easily customized using the dedicated smartphone app
- ▶ Can be used to relieve hearing aid fatigue

FUNCTIONAL DIAGRAM

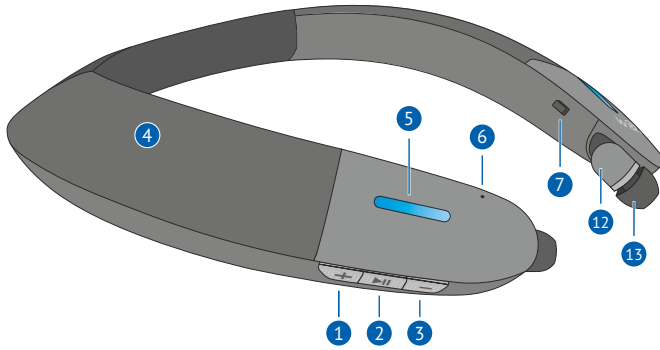

- ① Volume up
- ② Multifunction button
- ③ Volume down
- ④ Loudspeakers (left & right)
- ⑤ Notification LED (left & right)
- ⑥ Microphone
- ⑦ Left retract button

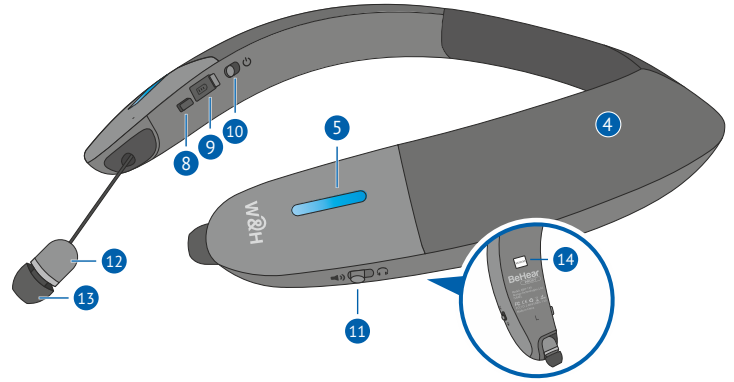

- ⑧ Right retract button
- ⑨ Micro USB charging port
- ⑩ Power ON/OFF switch
- ⑪ Mode switch
- ⑫ Extractable earphones (left & right)
- ⑬ Silicone earbuds (left & right)
- ⑭ Serial number label

ELECTRICAL SPECIFICATIONS

Bluetooth

- ▶ Bluetooth compliance: Bluetooth v.4.2 + EDR + Low Energy
- ▶ Supported Bluetooth profiles: HFP v1.6, HSP v1.2, A2DP v1.2
- ▶ Bluetooth transmission power: Class II, +4dBm
- ▶ Operating range: 10m (~33 ft)
- ▶ Paired devices: Supports two simultaneous connections (multi-point)

Audio

Loudspeakers

- ▶ Frequency range: 20Hz – 20kHz
- ▶ Sensitivity: 102dB ± 3dB @ 1mW

Earphones

- ▶ Frequency range: 20Hz – 20kHz
- ▶ Sensitivity: 102dB ± 3dB @ 1mW

Microphone

- ▶ Type: Omni-directional MEMS
- ▶ Frequency range: 50Hz – 10kHz

Battery

- ▶ Battery capacity: 1050mAh
- ▶ Operation Time:
 - Personal sound amplification: up to 50 hours
 - Calls (via earphones): up to 45 hours
 - Media play (via earphones): up to 40 hours
 - Media play (via loudspeakers): up to 10 hours
- ▶ Standby time: ≥ 1300 hours
- ▶ Charging time: ~3 hours
- ▶ Charging interface: micro-USB

MECHANICAL SPECIFICATIONS

- ▶ Wearing style: Around the neck
- ▶ Weight: 256g (9 oz.)

CERTIFICATIONS

- ▶ FCC
- ▶ CE RED



Specifications are subject to change without prior notice.